

PRODUCT DATA SHEET

DISC CONNECTOR IN

The disc connector In, made from polyoxymethylene (POM), is used in both vacuum and infusion processes. The flat disc surface rests beneath the vacuum film and ensures a secure seal. The central hose nozzle allows the connection of lines that can be used for either resin supply or vacuum extraction, depending on the setup.

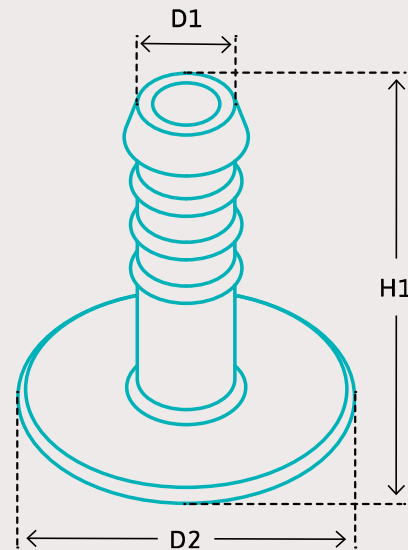

Grooves on the underside →

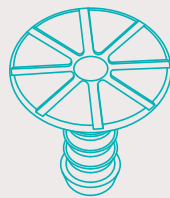

- + Grooves on the underside of the disc for improved resin or air supply
- + Flat contact surface under the film for reliable sealing
- + Suitable for resin and vacuum lines
- + Robust POM – stiff, wear-resistant, and chemical-resistant
- + Temperature range -40 °C to +90 °C, short-term up to +110 °C*

*The temperature resistance depends on the specific application and medium. The customer is responsible for verifying the suitability of the product under their individual operating conditions.

Disc Connector In



Item No.	Ø-Hose	PU	Material	D1	D2	H1
TV-08-100	8 mm	100	POM	8 mm	34 mm	35 mm
TV-10-100	10 mm	100	POM	10 mm	34 mm	35 mm
TV-12-100	12 mm	100	POM	12 mm	43 mm	43 mm